

AVK PRODUCT RANGE



THE SOLUTIONS  
YOU NEED  
THE STANDARDS  
YOU EXPECT

Expect... **AVK**



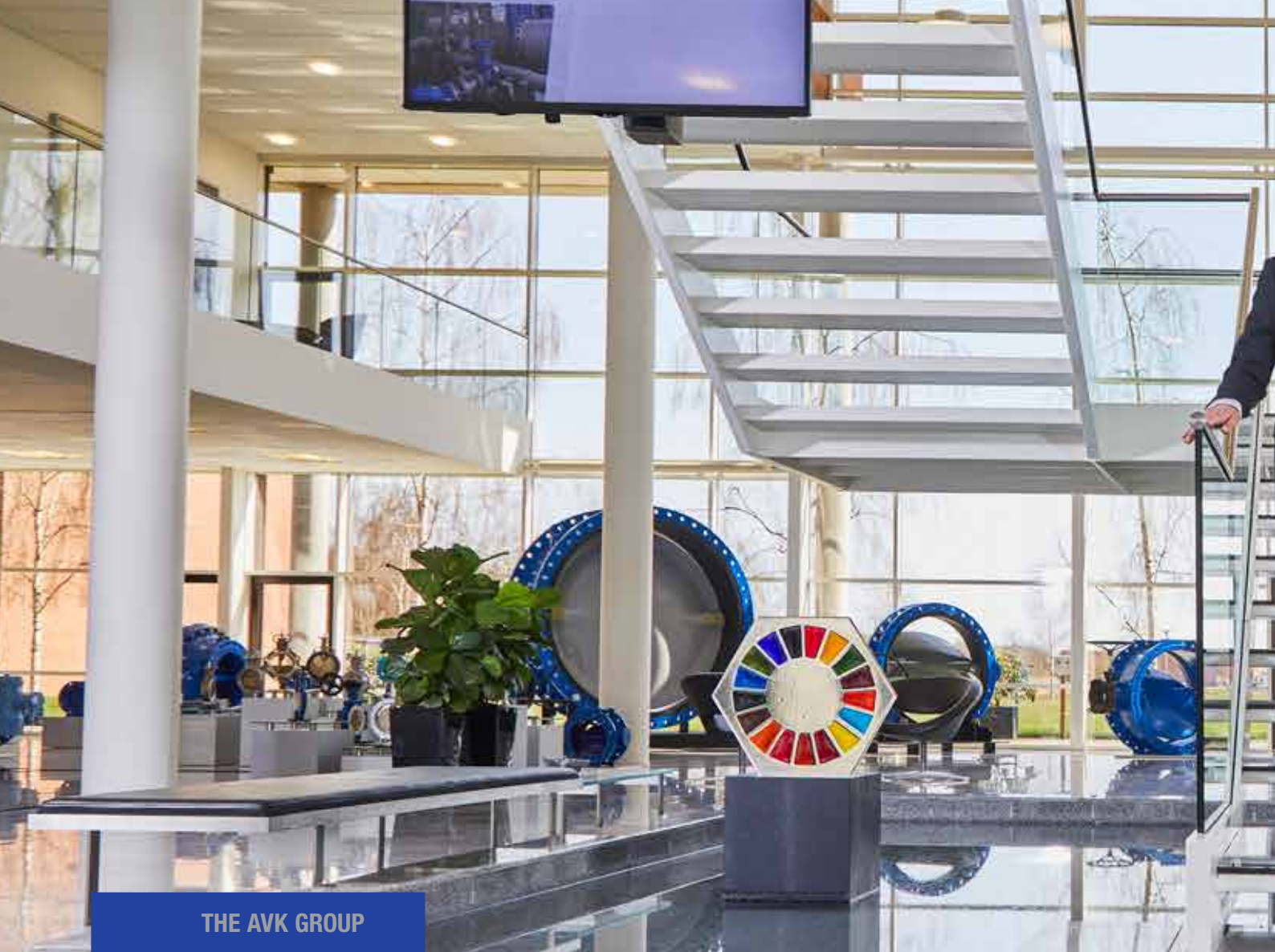

## THE AVK GROUP



### DEDICATED PEOPLE

4,800+ employees,  
hereof approx. 230 in  
AVK International A/S



### GLOBAL ORGANISATION

100+ AVK companies  
worldwide



### CONTINUOUS GROWTH

Net turnover EUR 1065  
million (2022/23)

# AVK YOUR LONG-TERM PARTNER



AVK has been in the valve business for more than 50 years. Today AVK is a global leader within valves, hydrants and accessories for water supply, gas supply, wastewater treatment and fire protection.

#### **The wide AVK range**

AVK International A/S specialise in manufacturing gate valves, double eccentric butterfly valves, ball check valves, service connection valves, Supa Maxi™ couplings, extension spindles and selected types of hydrants and accessories.

We add numerous products to our range from the more than 20 other AVK factories in Europe as well as from AVK factories worldwide. These AVK factories specialise in other types of valves, hydrants and accessories, and jointly we are capable of offering a very wide selection of high quality products.

#### **Global leadership and local commitment**

Our geographical presence and product range is global, but our focus is local. Our customers are serviced by local sales organisations, in AVK's own sales companies or within our carefully selected distributors, who engage in their customers' needs. We are therefore able to offer tailor-made solutions that match local specifications.

#### **A beneficial partnership**

We want to build and invest in a longterm partnership with our customers. To earn our role as a long-term partner, we strive to deliver value for money. We deliver error-free, durable and maintenance-free products that constitute the most cost-efficient solution for our partners in the long run.

# EXPECT QUALITY IN EVERY STEP

## State-of-the-art rubber technology

It is crucial that the rubber components inside valves, hydrants and accessories are of the highest quality to ensure a safe, watertight seal and trouble-free operation, even after many years without use. In our rubber factory, AVK GUMMI A/S, we develop and produce our own rubber components to make sure that they meet our uncompromising standards of excellence.

Our gate valve wedge design and other market-leading innovations provide the reliability you need to safeguard your network, your supply and the health and safety of your customers. This is especially important within water supply to avoid contamination and within gas supply to avoid even the tiniest leakage. AVK is the safe choice since we give high priority to quality and compliance.

For over 40 years, AVK GUMMI has made rubber components for the water, natural gas, healthcare and food industries. Our complete production control and one of the world's most advanced mixing plants enable us to offer rubber compounds of exceptional quality and uniformity, which are approved worldwide for drinking water, gas and many other applications.

## Streamlined processes facilitate short lead times

In our factories, all our products undergo careful surface treatment and rigorous testing to ensure durability and to make certain they can withstand even the harshest environments. We are in full control of the supply chain from raw materials to finished product with meticulous attention to quality control, traceability and pressure testing of every single valve.

Based on LEAN principles, we have streamlined our work processes and flow of goods to ensure the fastest possible lead time. We store a large selection of AVK's product range in our 13,000 m<sup>2</sup> warehouse fitted with AGVs for automated internal transport, and our warehouse management system enables us to optimise our inventory and handling. Altogether, this allows us to offer great delivery service.



# EXPECT US TO TAKE RESPONSIBILITY

## Water is a scarce resource

Access to clean water is often taken for granted, just like the fresh air we breathe. But we are facing an invisible, yet crucial problem of water loss, also referred to as non-revenue water. Non-revenue water is water that has been produced and cleaned but which is lost somewhere in the water distribution system without being used or paid for. The levels of non-revenue water range from about 5% to as much as 80% in certain areas.

AVK offers a wide range of reliable and long-lasting valves ensuring tightness many years after the valves have been installed, no matter if they have been used frequently or not at all. Our control valves contribute to efficient water supply management by maintaining a certain pressure, flow or level, regardless of changes in the supply network. Our digital monitoring solutions make it possible to save resources, reduce water loss and optimise network

activities. Our air valves and check valves contribute to extending the life span of the water network by reducing pipe stress. And in case of pipe leakages, we offer a wide range of collars and clamps for efficient pipe repair.

## Focus on sustainability

Our products are parts of vital infrastructure including water supply, wastewater treatment and energy supply that all together contribute to sustainable development, the health of people and a better environment. By delivering high-quality and long-lasting solutions we minimise environmental impacts caused by excavation, repair or replacement.

We have initiated the process of mapping, tracking and measuring the CO<sub>2</sub> emissions in our operations and per product. Minimum energy consumption is a core criterion of our design and production process and of our investments, and we have implemented the

ISO 50001 standard for Energy Management and the ISO 14001 standard for Environment Management. In addition, AVK suppliers must comply with our ethical standards to be a certified supplier of the AVK Group.

## Supporting world-transforming goals

Our solutions contribute to the UN sustainable development goals by ensuring clean water and sanitation, by reducing water loss, electricity consumption and CO<sub>2</sub> emissions, and by turning wastewater into affordable and clean energy. AVK has entered into partnerships with other leading Danish companies with the purpose of sharing knowledge within water technology and offering joint solutions for a more sustainable world.



# EXPECT LASTING INNOVATIONS



## **Inhouse R&D**

In our Development Department in Denmark, ideas and suggestions for new products are gathered, and existing products are updated continuously.

We use FEA (Finite Element Analysis) to optimise the strength and geometry of our components and CFD (Computational Fluid Dynamics) analyses to validate different product designs prior to creating physical prototypes. This enables us to predict consequences in cases where it is impossible to create full scale tests on physical products.

We make our own test and production equipment, and in our flow lab, we conduct thorough prototype and life cycle tests prior to release for production. New product types are generally field tested in co-operation with end users before final launch.

## **Quality certifications**

AVK's quality management system is certified according to ISO 9001 and the ISO 29001 standard for the oil and gas industry. Moreover, we are certified to the ISO 14001 standard for environmental management, the ISO 50001 standard for Energy Management, and the ISO 45001 standard for occupational health and safety.



# EXPECT US TO EXCEED MARKET STANDARDS

## Third party certification

Authorities such as DVGW (Germany), KIWA (Netherlands) and UL & FM (the US) offer certification of finished valves, and these are also recognized and accepted by other countries that do not have their own certification schemes.

By obtaining and maintaining the most widely accepted certification, we show our customers that AVK valves always meet the highest quality and safety standards.



## Expect... AVK

In our business there are five cornerstones that must be in place in order to meet customer expectations: Quality, reliability, innovation, sustainability and customer service.

But we need to go further than that. We go further to exceed our customers' needs and expectations.

"Expect... AVK" means that our customers should rightfully expect us to exceed market standards. "Expect... AVK" means that we relentlessly strive for increased customer benefits!

To ensure that we keep pushing the boundaries of what the market can expect, we have formulated promises that we will strive to deliver in all our markets:

- EXPECT** A LONG-TERM PARTNERSHIP
- EXPECT** QUALITY IN EVERY STEP
- EXPECT** LASTING INNOVATIONS
- EXPECT** TOTAL SAVINGS
- EXPECT** SOLUTIONS, NOT JUST PRODUCTS
- EXPECT** GLOBAL LEADERSHIP AND LOCAL COMMITMENT
- EXPECT** PROMPT RESPONSE
- EXPECT** IT TO BE EFFECTIVE AND EASY

See more on [www.avkvalves.eu](http://www.avkvalves.eu)





### Water supply

Gate valves and accessories, butterfly valves, check valves, regulating valves, air valves, hydrants, couplings, repair collars and clamps, fittings etc



### Wastewater treatment

Gate valves, knife gate valves, ball and swing check valves, butterfly valves, air valves, penstocks, couplings, repair collars and clamps.

# CORE BUSINESSES

#### Part of vital infrastructures

AVK has delivered gate valves to the water supply sector since the company was established in 1969, and today AVK is a global leader offering an extensive range of valves, hydrants and accessories. In the 70s we obtained our first DVGW approval for gas valves, and due to our high uniform quality and focus on safety and traceability, AVK is still a trusted supplier to the gas supply sector worldwide. For wastewater treatment we offer a very wide valve range according to all major standards as well as customized solutions. The AVK Group is among the largest manufacturers of fire hydrants worldwide and our range

includes UL/FM/VdS approved hydrants, gate and butterfly valves for fire protection.

#### AVK's products are securing:

- Clean drinking water without contamination or waste of water in the distribution network
- Efficient handling and cleaning of wastewater from households and industries
- Safe distribution of natural gas enabling a wide use of this eco-friendly energy source for heating, cooking and production
- Reliable fire equipment and water supply enabling firefighters to react fast and efficiently in dangerous situations





#### Gas supply

Gate valves and accessories, ball valves, butterfly valves, couplings and repair clamps.



#### Fire protection

Fire hydrants, monitors, gate valves, post indicators, butterfly valves, check valves and accessories.

# PRODUCT FEATURES AND BENEFITS

#### Product range brochures

Brochures for each of our core businesses are available for download from our website. Here we explain the features and benefits of each main product group and give a detailed overview of AVK's range within water supply, wastewater treatment, gas supply and fire protection.

Find much more information at [www.avkvalves.eu](http://www.avkvalves.eu)



# FLANGED GATE VALVES FOR WATER



**Series 06/30**  
Flanged gate valve  
Face-to-face DIN F4  
DN40-1200  
PN10/16  
Ductile iron

Options:  
• internal enamel  
• duplex stem  
• replaceable stem sealing



**Series 06/52**  
Premium 100 gate valve  
Flanged  
Face-to-face DIN F4  
DN40-600  
PN10/16  
Ductile iron  
External PUR coating



**Series 06/35**  
Flanged gate valve  
with position indicator  
Face-to-face DIN F4  
DN50-400  
PN10/16  
Ductile iron

Options:  
• face-to-face DIN F5



**Series 15/42**  
Flanged gate valve  
with ISO top flange for  
actuator  
Face-to-face DIN F4  
DN40-400  
PN10/16  
Ductile iron

Options:  
• face-to-face DIN F5



**Series 02/60**  
Flanged gate valve  
Face-to-face DIN F5  
DN40-500  
PN10/16  
Ductile iron

Options:  
• internal enamel  
• PN25  
• duplex stem  
• to GOST



**Series 02/75**  
Flanged gate valve  
Face-to-face DIN F5  
Replaceable stem sealing  
DN40-500  
PN10/16  
Ductile iron

Options:  
• PN25



**Series 02/52**  
Premium 100 gate valve  
Flanged  
Face-to-face DIN F5  
DN40-500  
PN10/16  
Ductile iron  
External PUR coating



**Series 02/20**  
Flanged gate valve  
Face-to-face BS  
DN50-400  
PN10/16  
Ductile iron



**Series 55/30**  
Flanged gate valve  
DN450-500-600-800  
Face-to-face DIN F5  
PN10/16  
Ductile iron  
Resilient seated  
Replaceable stem sealing

Options:  
• DN80 By-pass



**Series 54**  
Flanged gate valve  
DN700-800-900  
Face-to-face BS  
PN10/16  
Ductile iron  
Metal seated

Options:  
• DN80 By-pass



**Series 18/70**  
Combi-cross  
with 4 outlets  
DN100-300  
PN10/16  
Ductile iron

Options:  
• with ball valve service outlets  
• with blind flange on DN100 centre outlet  
• with 3 outlets  
• DN80 center outlet



**Series 18/01**  
Combi-cross  
flexible design  
DN100-400  
PN10/16  
Ductile iron

Options:  
• with ball valve service outlets  
• with blind flange on centre outlet  
• duplex stem



# GATE VALVES WITH PE-ENDS, SPIGOT, COUPLINGS AND SOCKET ENDS FOR WATER



**Series 36/80**  
Gate valve with PE ends  
DN65-500  
PE100/SDR11

Od75-630 mm  
Ductile iron

- Options:
- SafeTech ends
  - duplex stem
  - PE100/SDR17



**Series 36/52**  
Premium 100 gate valve with PE ends  
DN65-400  
PE100/SDR11

Od75-400 mm  
Ductile iron  
External PUR coating

- Options:
- Black/blue pipe ends up to 630 mm
  - PE100/SDR17

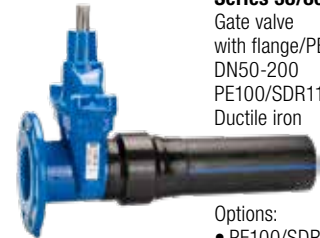

**Series 38/80**  
Gate valve with flange/PE end  
DN50-200  
PE100/SDR11  
Ductile iron

- Options:
- PE100/SDR17



**Series 638**  
Gate valve with Supa Maxi™/PE end  
DN80-300  
PE100/SDR11  
Ductile iron

- Options:
- PE100/SDR17



**Series 636**  
Supa Maxi™ gate valve  
Universal and tensile coupling ends for all pipes  
DN80-300  
PN16  
Ductile iron



**Series 01/70**  
Supa Plus™ gate valve with tensile coupling ends for PE and uPVC pipes  
DN40-300  
PN16  
Ductile iron

- Options:
- duplex stem



**Series 12/51**  
Gate valve with flange/spigot end for cast iron pipes  
DN50-300  
PN10/16  
Ductile iron



**Series 32/40**  
Gate valve with long spigot ends for cast iron pipes  
DN80-300  
PN16  
Ductile iron

- Options:
- short spigot ends for D.I. pipes or AC pipes



**Series 06/38**  
Gate valve with grooved ends  
DN50-300  
PN16  
Ductile iron



**Series 01/80**  
Gate valve with "Euro" socket ends for uPVC-pipes  
DN40-400  
PN16  
Ductile iron

- Options:
- duplex stem



**Series 33/00**  
Gate valve with socket ends for cast iron pipes  
DN80-300  
PN16  
Ductile iron  
With internal enamel

- Options:
- internal epoxy



**Series 33/50**  
Gate valve with BLS® socket end/ BLS® spigot end for cast iron pipes  
DN80-300  
PN16  
Ductile iron



# CHECK VALVES AND BUTTERFLY VALVES FOR WATER



**Series 41/60**  
Swing check valve  
Resilient seated  
Free shaft  
DN50-300  
PN10/16  
Ductile iron

- Options:
- lever and weight
  - lever and spring
  - closed bushings
  - prepared for limit switch



**Series 41/36**  
Swing check valve  
Metal seated  
Closed bushings  
DN350-600  
PN10/16  
Ductile iron

- Options:
- free shaft



**Series 874**  
Tilting disc check valve  
With lever and weight  
DN150-1600  
PN10/16  
Ductile iron

- Options:
- hydraulic damper



**Series 875**  
Slanted seat check valve  
DN200-1000  
PN10/16  
Ductile iron



**Series 820/00**  
Butterfly valve  
Centric with loose liner  
Wafer type  
DN25-1000  
PN10/16  
Ductile iron

- Options:
- various actuators



**Series 820/10**  
Butterfly valve  
Centric with loose liner  
Lug type  
DN25-600  
PN10/16  
Ductile iron

- Options:
- various actuators



**Series 820/20**  
Butterfly valve  
Centric with loose liner  
U-section type  
DN150-1600  
PN10/16  
Ductile iron

- Options:
- various actuators



**Series 75/10**  
Butterfly valve  
Centric with fixed liner  
Wafer type  
DN40-1400  
PN10/16  
Ductile iron

- Options:
- semi lug type
  - full lug
  - various actuators



**Series 75/20**  
Butterfly valve  
Centric with fixed liner  
Double flanged short  
DN50-2000  
PN10/16  
Ductile iron

- Options:
- double flanged long
  - various actuators



**Series 756/100**  
Butterfly valve  
Double eccentric  
Double flanged  
Integral seat  
IP 67 gearbox  
DN150-2800  
PN10/16  
Ductile iron

- Options:
- internal enamel
  - stainless steel seat
  - IP 68 gearbox
  - ISO-input gearbox
  - PN25 in DN150-1200



**Series 756/102**  
Butterfly valve  
Double eccentric  
Double flanged  
Stainless steel seat  
ISO-input gearbox  
DN150-2800  
PN10/16  
Ductile iron

- Options:
- integral seat
  - IP 67 gearbox
  - IP 68 gearbox
  - PN25 in DN150-1200



# CONTROL VALVES, NEEDLE VALVES, AIR VALVES AND FLOAT VALVES FOR WATER



**Series 859**  
Control valve  
Pressure reducing  
DN50-600  
PN10/16  
Ductile iron/AISI 316



**Series 859**  
Control valve  
Pressure sustaining  
DN50-600  
PN10/16  
Ductile iron/AISI 316



**Series 859**  
Control valve  
Constant flow  
DN50-600  
PN10/16  
Ductile iron/AISI316



**Series 872**  
Needle valve  
DN 80-1600  
PN 10/16/25/40  
Stainless steel DN80-150  
Ductile iron from DN200

- Options:
- various actuators and accessories
  - up to PN100 and DN2000



**Series 701/10**  
Automatic air valve  
Threaded BSP ¾" or 1"  
DN20-25  
PN16  
Reinforced polyamide

- Options:
- brass base
  - ductile iron



**Series 701/30**  
Air & vacuum valve  
Inlet flange  
DN50-300  
PN16  
Ductile iron



**Series 701/40**  
Combination air valve  
DN20, 25 and 50  
Threaded BSP ¾", 1" or 2"  
PN16  
Reinforced polyamide



**Series 701/46**  
Combination air valve  
High flow  
Threaded BSP 2"/DN50-150 inlet flange  
PN16  
Ductile iron



**Series 701/50**  
Combination air valve  
Inlet flange  
DN50-300  
PN16  
Grey cast iron/reinforced polyamide

- Options:
- ductile iron



**Series 701/84**  
Underground air valve installation system  
DN50-100  
PN16  
Air valve box of PVC



**Series 851/41**  
Combination air valve  
DN50-200  
ABS float

- Options:
- stainless steel float

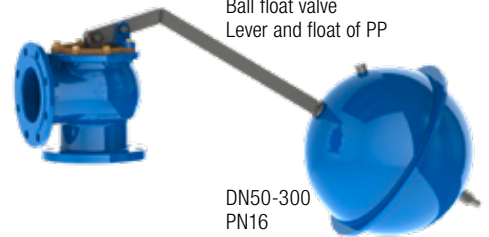

**Series 854**  
Ball float valve  
Lever and float of PP

DN50-300  
PN16  
Ductile iron

- Options:
- lever and float of stainless steel



# SERVICE CONNECTION VALVES FOR WATER



**Series 03/00**  
Service connection valve with internal BSP thread  
DN25-50  
PN16  
Ductile iron

Options:  
• internal enamel



**Series 03/30**  
Service connection valve with tensile socket ends for PE pipes  
DN20-50  
PN16  
Ductile iron

Options:  
• for side tapping with internal thread/external thread



**Series 03/65**  
Service connection valve with tensile screw couplings for PE pipes  
DN25-50  
PN16  
Ductile iron

Options:  
• tensile screw coupling for PE pipes/external thread



**Series 03/90**  
Service connection valve with PRK couplings for PE pipes  
DN20-50  
PN16  
Ductile iron

Options:  
• internal enamel



**Series 16/05**  
Service connection valve with tensile screw couplings for PE pipes  
DN25-50  
PN16  
Brass

Options:  
• PRK couplings  
• T-type bonnet



**Series 36/8X**  
Service connection valve with PE ends  
DN25-50  
PE100/PN10  
Ductile iron

Options:  
• PE100/PN16  
• duplex stem



**Series 36/5X**  
Premium 100 service connection valve with PE ends  
DN25-50  
PE100/PN10

Ductile iron  
External PUR coating

Options:  
• PE100/PN16



**Series 16/50**  
Service connection valve with tensile socket ends for PE pipes  
DN25-50  
PN16  
POM (Polyoxymethylene)

Options:  
• external thread/tensile socket end  
• T-type bonnet  
• duplex stem



**Series 16/59**  
Service connection valve with Pentomech™ couplings  
DN25-50  
PN16  
POM (Polyoxymethylene)

Options:  
• duplex stem



**Series 16/80**  
Service connection valve with PE ends  
DN25-50  
PE100/PN16

POM (Polyoxymethylene)

Options:  
• T-type bonnet  
• duplex stem



**Series 16/90**  
Service connection valve with PRK couplings  
DN25-50  
PN16  
POM (Polyoxymethylene)

Options:  
• PRK coupling/external thread  
• T-type bonnet  
• duplex stem



**Series 11/30**  
Service connection angle valve with external thread on inlet and tensile socket end for PE pipes on outlet  
DN25-50  
PN16  
Ductile iron

Options:  
• internal thread on outlet



# SUPA LOCK™ THREADLESS CONNECTION SYSTEM FOR WATER



**Series 103/00**  
Service connection valve with Supa Lock™ spigot/socket end  
DN32  
PN16  
Ductile iron

- Options:
- Supa Lock™ spigot end/PRK coupling
  - duplex stem



**Series 103/31**  
Angle service connection valve with Supa Lock™ spigot/push-in socket end  
DN32  
PN16  
Ductile iron

- Options:
- Supa Lock™ spigot/socket end
  - duplex stem



**Series 343/81**  
Ball valve with Supa Lock™ spigot end/BSP thread 1"-1½"  
DN32, PN16  
Brass

- Options:
- Supa Lock™ spigot end/PRK coupling
  - Supa Lock™ spigot end/screw coupling
  - with T-type bonnet



**Series 100/14**  
Tapping saddle for iron/steel pipes  
Ø 60-223 mm  
DN32  
Ductile iron

- Options:
- for PE/PVC pipes



**Series 100/85**  
Tapping saddle with blade shut-off for iron/steel pipes  
Ø 50-360 mm  
DN32  
Ductile iron/stainless steel

- Options:
- for PE/PVC pipes



**Series 107/74**  
Tapping head with blade shut-off  
DN32  
Ductile iron



**Series 107/31**  
90° push-in fitting for PE pipes  
Ø 32-63 mm  
DN32  
Ductile iron

- Options:
- straight push-in fitting for PE pipes
  - 45° push-in fitting
  - Supa Lock™ socket end



**Series 107/36**  
Fitting with PE pipe end  
Ø 32-40 mm  
DN32  
Ductile iron



**Series 106/01**  
Fitting with PRK coupling for PE pipes  
Ø 32-40 mm  
DN32  
Ductile iron

- Options:
- Double spigot fitting



**Series 106/02**  
Fitting with screw coupling for PE pipes  
Ø 32-50 mm  
DN32  
Brass

- Options:
- PRK coupling
  - Sensor fitting



**Series 106/02**  
Threaded connector For connection to drilling machines  
1"-2"  
DN32  
Brass

- Options:
- ductile iron
  - Threaded transition connector



**Series 109/10**  
Spacer for flanged connections  
DN80-400  
DN32  
Ductile iron

- Options:
- 3-way socket fitting
  - socket/tyton fittings
  - blind flange



# HYDRANTS FOR WATER



**Series 84/05**  
Above ground fire hydrant  
Break-away design with  
additional ball shut-off  
Model P7  
DN80/100  
PN16  
Ductile iron

- Options:  
• lateral flange



**Series 84/72**  
Above ground fire hydrant  
Break-away design with  
additional ball shut-off  
Model P7  
DN80/100  
PN16  
Stainless steel

- Options:  
• lateral flange



**Series 84/45**  
Above ground fire hydrant  
Break-away design with  
additional ball shut-off  
Model P7  
"NOSTALGIA"  
DN80  
PN16  
Ductile iron

- Options:  
• lateral flange  
• various coatings



**Series 84/91**  
Above ground fire hydrant  
Breakable single shut-off  
Model N7  
DN80/100  
PN16  
Stainless steel

- Options:  
• non breakable  
• double shut-off  
• ductile iron

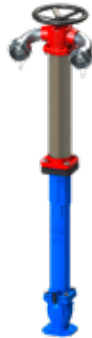

**Series 84/93**  
Tunnel fire hydrant  
Breakable double shut-off  
Model N7  
DN80  
PN16  
Stainless steel



**Series 09/30**  
Above ground fire hydrant  
Screw down type B  
DN80  
PN10  
Ductile iron

- Options:  
• manual or automatic  
drainage  
• aluminium body  
• gate valve operated



**Series 29/40**  
Underground fire hydrant  
with bayonet coupling  
DN100  
PN16  
Ductile iron

- Options:  
• 3" stortz oupling  
• 3" NOR coupling  
• 4" stortz coupling



**Series 29/50**  
Underground fire hydrant  
with bayonet coupling  
With AVK extension  
spindle and riser pipe in  
stainless steel  
DN100  
PN16  
Ductile iron



**Series 29/78**  
Underground fire hydrant  
Free flow  
Single shut-off  
DN80  
PN16  
750-1500 mm  
Ductile iron



**Series 35/31**  
Underground fire hydrant  
Single shut-off  
DN80  
PN16  
750-1500 mm  
Ductile iron

- Options:  
• stainless steel seat  
• backflow prevention



**Series 35/8X**  
Underground fire hydrant  
Additional ball shut-off  
DN80  
PN16  
750-1500 mm  
Ductile iron  
Stainless steel seat



**Series 35/72**  
Underground fire hydrant  
DN100-125  
PN16  
1000-3500 mm  
Ductile iron

- Options:  
• drilling according to  
GOST





# GATE VALVES, BUTTERFLY VALVES AND KNIFE GATE VALVES FOR WASTEWATER



## Series 06/80

Flanged gate valve  
Face-to-face DIN F4  
DN40-600  
PN10/16  
NBR wedge  
Ductile iron

### Options:

- AISI 316 stem
- face-to-face DIN F5



## Series 06/35

Flanged gate valve  
with position indicator  
Face-to-face DIN F4  
DN50-400  
PN10/16  
EPDM wedge  
Ductile iron

### Options:

- NBR wedge
- face-to-face DIN F5



## Series 15/42

Flanged gate valve  
for electric actuator  
Face-to-face DIN F4  
DN40-400  
PN10/16  
Ductile iron

### Options:

- face-to-face DIN F5
- hydraulic/pneumatic actuator
- NBR wedge



## Series 715

Flanged gate valve  
with hydraulic actuator  
Face-to-face DIN F4  
DN65-300  
PN10/16  
NBR wedge  
Ductile iron

### Options:

- solenoid valve kit and proximity switches



## Series 06/89

Flanged gate valve  
with rising stem  
Face-to-face DIN F4  
DN50-400  
PN10/16  
Ductile iron



## Series 16/54

Service connection valve  
with tensile socket ends  
for PE pipes  
DN25-50  
PN16  
POM (Polyoxymethylene)

### Options:

- ductile iron



## Series 820/00

Butterfly valve  
Centric with loose liner  
Wafer type  
DN25-1000  
PN10/16  
Ductile iron

### Options:

- for frequent operation
- various actuators



## Series 820/10

Butterfly valve  
Centric with loose liner  
Lug type  
DN25-600  
PN10/16  
Ductile iron

### Options:

- for frequent operation
- U-section type
- various actuators



## Series 75/10

Butterfly valve  
Centric with fixed liner  
Wafer type  
DN40-1400  
PN10/16  
Ductile iron

### Options:

- various actuators



## Series 75/31

Butterfly valve  
Centric with fixed liner  
Semi lug type  
DN50-300  
PN10/16  
Ductile iron

### Options:

- full lug type
- various actuators



## Series 75/20

Butterfly valve  
Centric with fixed liner  
Double flanged short  
DN50-2000  
PN10/16  
Ductile iron

### Options:

- double flanged long
- various actuators



## Series 702/20

Knife gate valve  
with handwheel and  
rising stem  
DN50-1200  
PN10  
Ductile iron

### Options:

- handwheel and non-rising stem
- chainwheel
- electric or pneumatic actuator
- lever



# CHECK VALVES, AIR VALVES AND PENSTOCKS FOR WASTEWATER



**Series 41/61**  
Swing check valve  
Closed bushings  
Resilient seated  
DN50-300  
PN10/16  
Ductile iron



**Series 41/60**  
Swing check valve  
Free shaft  
Resilient seated  
DN50-300  
PN10/16  
Ductile iron



**Series 41/36**  
Swing check valve  
Metal seated  
Closed bushings  
DN350-600  
PN10/16  
Ductile iron

- Options:
- lever and weight
  - lever and spring
  - prepared for limit switch

- Options:
- free shaft



**Series 53/35**  
Ball check valve  
with flanged ends  
DN50-600  
PN10  
Ductile iron



**Series 53/42**  
Ball check valve  
with flanged ends  
DN80-150  
PN10  
Stainless steel AISI 316



**Series 53/30**  
Ball check valve  
with internal thread  
DN32-50  
PN10  
Ductile iron

- Options:
- stainless steel  
DN32-80



**Series 701/33**  
Air & vacuum valve  
DN80-100  
PN16  
Steel



**Series 701/76**  
Combination air valve  
DN50-200  
PN16  
Stainless steel

- Options:
- steel
  - large combination air valve



**Series 701/75**  
Combination air valve  
DN50-200  
PN10  
Reinforced polyamide

- Options:
- PN16



**Series 701/79**  
Underground air valve  
system  
DN50-100  
PN10  
External box of  
polypropylene



**Series 772/61**  
Wall penstock  
Bi-directional up to and  
incl. 1200 x 1200 mm,  
in larger sizes bi- or uni-  
directional  
With non-rising stem  
Stainless steel  
AISI 304  
200 x 200 mm -  
2000 x 2000 mm

- Options:
- rising stem
  - AISI 316



**Serie 772/7172**  
Channel penstock  
Uni-directional up to and  
incl. 1000 x 1000 mm,  
bi-directional in larger  
sizes  
With non-rising stem  
Stainless steel  
AISI 304  
200 x 200 mm -  
2000 x 2000 mm

- Options:
- rising stem
  - AISI 316



# GATE VALVES, BALL VALVES AND BUTTERFLY VALVES FOR GAS



**Series 36/90**  
Gate valve with PE ends  
DN65-400  
PE100/PN10 SDR 11  
Ductile iron

External epoxy coating

Options:

- PE100/PN10/4
- flange/PE end
- ISO top flange
- external PUR coating



**Series 46/64**  
Gate valve  
with short spigot ends  
DN50-300  
PN16  
Cast steel GP240GH  
External epoxy coating

Option:

- external PUR coating

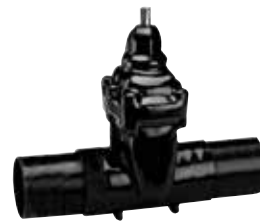

**Series 46/70**  
Gate valve  
with long spigot ends  
DN50-600  
PN16  
Cast steel GP240GH  
External PUR coating

Option:

- external epoxy coating
- ISO top flange



**Series 46/80**  
Gate valve with long  
spigot ends and two  
purge points  
DN80-600  
PN16  
Cast steel GP240GH  
External PUR coating



**Series 46/90**  
Gate valve with steel/PE  
spigot ends  
DN50-300  
PN10

Cast steel GP240GH  
External epoxy coating

Options:

- external PUR coating



**Series 02/70**  
Flanged gate valve  
Face-to-face DIN F5  
DN40-500  
PN10/16  
Ductile iron  
External epoxy coating

Options:

- position indicator



**Series 06/70**  
Flanged gate valve  
Face-to-face DIN F4  
DN40-600  
PN10/16  
Ductile iron  
External epoxy coating

Options:

- position indicator



**Series 15/78**  
Flanged gate valve  
with ISO top flange  
DN50-400  
PN10/16  
Ductile iron  
External PUR coating

Option:

- external epoxy coating



**Series 36/9X**  
Service connection valve  
with PE ends  
DN25-50

PE100/PN10 or 4  
Ductile iron  
External epoxy coating

Options:

- external PUR coating



**Series 03/25**  
Service connection valve  
with internal thread  
DN25-50  
PN4  
Ductile iron  
External epoxy coating



**Series 85/30**  
Ball valve  
with spigot ends  
DN25/Ø20 mm -  
DN150/Ø180 mm  
PN10  
PE100

Options:

- lever
- support base



**Series 75/11**  
Wafer butterfly valve,  
centric with fixed liner  
DN50-600  
PN10/16  
Ductile iron

Options:

- semi-lug
- full lug
- double flanged



# HYDRANTS AND VALVES FOR FIRE PROTECTION



**Series 27/00**  
 Dry barrel fire hydrant  
 Modern style  
 Bury depth 305-2438 mm  
 17.2 bar/250 PSI  
 Ductile iron  
 UL/ULC listed,  
 FM approved

Inlet options:  
 • DN100-150 flanged  
 • DN100-150 PE end  
 • monitor fire hydrant



**Series 24/90**  
 Wet barrel fire hydrant  
 200 PSI  
 2 x 2½" + 1 x 4¼"  
 outlets  
 Ductile iron  
 UL listed, FM approved

Options:  
 • 1 x 2½" + 1 x 4¼"  
 outlets  
 • DN100 monitor flange  
 and 2 x 2½" + 1 x  
 4¼¼" outlets



**Series 06/35**  
 Flanged gate valve  
 with position indicator  
 DN50-400  
 PN10/16  
 Ductile iron  
 VdS approved  
 (DN50-200 only)



**Series 06/37**  
 Grooved end gate valve  
 with position indicator  
 DN50-300  
 PN16  
 Ductile iron  
 VdS approved  
 (DN50-200 only)



**Series 45/59**  
 Flanged gate valve  
 with post indicator flange  
 DN50-300:  
 17.2 bar/250 PSI  
 DN350-400:  
 13.7 bar/200 PSI  
 Ductile iron  
 UL/ULC listed,  
 FM approved

Options:  
 • PE ends



**Series 145 - 45**  
 Flanged gate valve  
 with rising stem  
 DN50-300:  
 17.2 bar/250 PSI  
 DN350-400:  
 13.7 bar/200 PSI  
 Ductile iron  
 UL/ULC listed,  
 FM approved

Options:  
 • with wrench nut



**Series 55**  
 Flanged gate valve  
 with wrench nut  
 DN450-600  
 13.7 bar (200 PSI)  
 Ductile iron  
 UL/ULC listed,  
 FM approved

Options:  
 • post indicator flange  
 • rising stem



**Series 75/20**  
 Butterfly valve  
 Centric with fixed liner  
 Double flanged short  
 DN50-300  
 PN10/16  
 Ductile iron  
 FM approved

Options:  
 • wafer  
 • semilug  
 • lug



**Series 34/00**  
 Post indicator, telescopic  
 for DN100-600 post  
 indicator gate valves  
 Bury depth: 505-2210 mm  
 Ductile iron  
 UL/ULC listed,  
 FM approved



**Series 34/80**  
 Wall post indicator  
 for DN100-400 post  
 indicator gate valves  
 Stem length: 250-1250 mm  
 Ductile iron  
 UL/ULC listed,  
 FM approved



**Series 5190/10**  
 Swing check valve  
 Spring loaded  
 Grooved ends to AWWA  
 C606  
 DN50-200  
 24.1 bar/350 PSI  
 FM approved

Options:  
 • shotgun type  
 • with flanges



**Series 230/31**  
 Grooved reducing Tee  
 DN50-300  
 20.6 bar (300 PSI)  
 Ductile iron  
 UL/ULC listed,  
 FM approved

Options:  
 • elbows  
 • adaptor flanges  
 • reducers  
 • caps  
 • mechanical Tees



# SUPA MAXI™, SUPA PLUS™ AND SUPA® COUPLINGS AND ADAPTORS



**Series 631/00**  
Supa Maxi™ universal  
tensile straight coupling  
DN50-800  
PN16  
Ductile iron

Options:  
• for gas PN10



**Series 632/00**  
Supa Maxi™ universal  
tensile step coupling  
DN40-300  
PN10/16  
Ductile iron

Options:  
• for gas PN10



**Series 633/00**  
Supa Maxi™ universal  
tensile flange adaptor  
DN40-800  
PN10/16  
Ductile iron

Options:  
• for gas PN10



**Series 634/00**  
Supa Maxi™ universal  
tensile end cap  
DN50-400  
PN16  
Ductile iron

Options:  
• for gas PN10



**Series 635/00**  
Supa Maxi™ universal  
tensile transition coupling  
with factory mounted  
PE pipe  
DN50-300  
PN10 or 16  
Ductile iron



**Series 621/10**  
Supa Plus™ coupling  
Tensile for PE and uPVC  
pipes  
DN32-300  
PN16  
Ductile iron



**Series 623/10**  
Supa Plus™ flange  
adaptor  
Tensile for PE and uPVC  
pipes  
DN40-300  
PN10/16  
Ductile iron



**Series 624/10**  
Supa Plus™ end cap  
Tensile for PE and uPVC  
pipes  
DN40-300  
PN16  
Ductile iron



**Series 601**  
Supa® universal straight  
coupling  
DN40-400  
PN16  
Ductile iron



**Series 602**  
Supa® universal step  
coupling  
DN40-400  
PN10/16  
Ductile iron



**Series 603**  
Supa® universal flange  
adaptor  
DN40-400  
PN10/16  
Ductile iron



**Series 05/08**  
Support bush  
for PE pipes  
DN50-600  
PN6.3, 10, 12.5 or 16  
Stainless steel



# COUPLINGS, DISMANTLING JOINTS AND TAPPING SADDLES



**Series 05**  
Combi-flange  
for PE and  
PVC pipes  
Non-tensile (PVC) DN50-600  
Tensile DN50-300  
PN10/16  
Ductile iron

- Options:
- for ductile iron pipes
  - for steel pipes (non-tensile)



**Series 258**  
Fabricated dedicated  
straight coupling  
for AC, steel, cast iron or  
ductile iron pipes  
DN350-2000  
PN8 to 25  
Steel

- Options:
- step coupling
  - flange adaptor

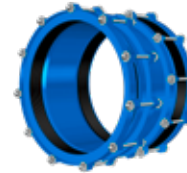

**Series 8004**  
Fabricated universal flange  
adaptor  
Steel  
DN400-2000  
PN16

- Options:
- straight coupling
  - stainless steel



**Series 745/01**  
Repico® grip coupling  
Universal and tensile for  
all metal pipes  
NBR or EPDM sealing  
DN15-400  
Stainless steel AISI 316

- Options:
- for medium pressure  
up to DN200



**Series 745/20**  
Repico® slip coupling  
Universal and non-tensile  
for all pipes  
NBR or EPDM sealing  
DN15-600  
Stainless steel AISI 316

- Options:
- 2 locks up to DN1000

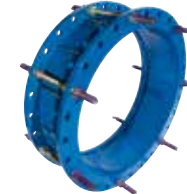

**Series 265**  
Dismantling joint  
for all types of pipes with  
flanged connections  
DN350-1200  
PN10/16/25  
Steel

- Options:
- with centre flange  
DN50-2200

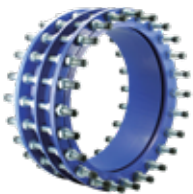

**Series 873**  
Dismantling joint for all  
pipe materials  
With centre flange  
DN40-2600  
PN10/16/25  
Ductile iron



**Series 10/00**  
Tapping saddle  
for uPVC and PE pipes  
DN50-300  
Ductile iron  
Lower part in stainless  
steel from DN250

- Options:
- for cast iron, ductile  
iron and steel pipes



**Series 730**  
Universal tapping saddle  
with blade shut-off  
for ductile iron, steel and  
other metal pipes  
DN50-300  
Ductile iron/steel

- Options:
- without blade shut-off



**Series 727/10**  
Tapping saddle  
with blade shut-off  
For PE and PVC pipes  
DN80-200  
Ductile iron



**Series 727/09**  
Tapping saddle SWIC  
for underpressure drilling  
With integrated cutter for  
PE and PVC pipes  
DN50-200  
Ductile iron

- Options:
- with integrated cutter  
for steel pipes



**Series 6731**  
Flanged universal tapping  
saddle with blade shut-  
off for iron, steel, PE and  
PVC pipes  
Ductile iron

- Options:
- slim type



# VALVE ACCESSORIES



**Series 04**  
Fixed surface box  
Grey cast iron  
Distance ring/square for fixed surface box

Options:  
• reversible design



**Series 80**  
Surface box "Classic"  
Fixed height  
Body of PA+

Options:  
• square or round  
• lid of cast iron or PA  
• for gate valves, service connection valves or underground hydrants



**Series 80**  
Surface box "Classic"  
Height adjustable  
Body of PA+

Options:  
• square or round  
• lid of cast iron or PA  
• for gate valves, service connection valves or underground hydrants



**Series 80**  
Surface box "Futura"  
Fixed height  
Body of PA+

Options:  
• square or round  
• lid of cast iron or PA  
• for gate valves, service connection valves or underground hydrants



**Series 04/007**  
Floating surface box  
for telescopic extension spindle  
Body of PE  
Flange and lid of ductile iron

Options:  
• round - black  
• round - blue epoxy  
• square - black  
• square - blue epoxy



**Series 04/008**  
Floating surface box  
for telescopic extension spindle  
Ductile iron

Options:  
• round or square surface plate  
• round or square lid  
• double surface box



**Series 04**  
Extension spindle  
for service connection valves  
DN25-50

Options:  
• telescopic or fixed length



**Series 04**  
Extension spindle  
for gate valves  
DN40-600

Options:  
• telescopic or fixed length  
• telescopic for double eccentric butterfly valves



**Series 04**  
Stem caps  
for gate valves and service connection valves  
DN25-600  
Ductile iron



**Series 08**  
Handwheel  
for gate valves  
DN50-600  
Grey cast iron

Options:  
• for double eccentric butterfly valves



**Series 756/5**  
Adaptor for connecting gearside to extension rod, wall post indicator or post indicator  
DN200-1200  
Ductile iron



**Series 910**  
Y-strainer  
DN50-300  
Ductile iron



# REPAIR COLLARS AND CLAMPS, FITTINGS AND FOUNTAIN POSTS



**Series 8001**  
Hydro Stop universal  
socket encapsulation  
collar  
Steel  
EPDM rubber  
DN250-2000

- Options:
- Pipe encapsulation collar
  - Customised design and larger DN's



**Series 8002**  
Hydro Fast dedicated  
socket encapsulation  
collar  
Steel  
EPDM rubber  
DN300-2000

- Options:
- Pipe encapsulation collar
  - Customised design and larger DN's



**Series 8003**  
Hydro Smart dedicated  
socket encapsulation  
collar  
Steel  
EPDM rubber  
DN80-250

- Options:
- Customised design



**Series 748/01**  
Repair clamp  
Single band  
Stainless steel AISI 304  
or AISI 316  
NBR or EPDM rubber

- Options:
- handgrip



**Series 748/02**  
Repair clamp  
Double band  
Stainless steel AISI 304  
or AISI 316  
NBR or EPDM rubber

- Options:
- handgrip



**Series 748/03**  
Repair clamp  
Triple band  
Stainless steel AISI 304  
or AISI 316  
NBR or EPDM rubber



**Series 712**  
Flanged bend  
Ductile iron

- Options:
- various types



**Series 712**  
Flanged cross  
Ductile iron

- Options:
- various types



**Series 712**  
Flanged reducer  
Ductile iron

- Options:
- various lengths



**Series 712**  
Reducer flange  
Ductile iron



**Series 712**  
Duckfoot bend  
Ductile iron



**Series 78/7510**  
Fountain post  
"VICTORIA"  
Frost-proof  
DN40  
Grey cast iron

- Options:
- outlet for fire hose connection





# SMART WATER IOT SENSORS AND SOFTWARE



**Series 3004/002**  
VID I Positioner  
Open/close position indicator for AVK extension spindles  
Wireless  
10-year battery life  
NB-IoT or LoRa® communication  
IP68



**Series 3004/101**  
VID I Positioner  
Open/close position indicator for gate valves  
Wireless  
10-year battery life  
NB-IoT or LoRa communication  
IP68



**Series 3002/002**  
VID I Cap  
Hydrant cap detecting open/close status  
For threaded Storz B outlet  
Wireless  
10-year battery life  
NB-IoT or LoRa® communication  
IP68



**Series 3001/001**  
VID I Pressure  
Sensor measuring water pressure  
Wireless  
10-year battery life  
NB-IoT or LoRa® communication  
IP68 (transmitter)



**Series 3001/002**  
VID I Flow  
Sensor transmitting water flow  
Wireless  
10-year battery life  
NB-IoT or LoRa® communication  
IP68 (transmitter)



**Series 3001/004**  
VID I Level  
Sensor measuring distance to nearest surface  
Wireless  
10-year battery life  
NB-IoT or LoRa® communication  
IP68 (transmitter)  
IP67 (level sensor)



**Series 3001/003**  
VID I Temperature  
Sensor measuring water temperature  
Wireless  
10-year battery life  
NB-IoT or LoRa® communication  
IP68 (transmitter)



**Series 3004/001**  
VID I Open/Close  
Open/close position indicator for AVK valves  
Wireless  
10-year battery life  
NB-IoT or LoRa® communication  
IP68 (transmitter)



**Series 3005/001**  
Outdoor LoRaWAN®-gateway  
for series 3001, 3002 and 3004  
SIM card  
Ethernet (RJ45)  
IP67



**Series 3005/002**  
VID I software  
for collecting and visualising data  
Access through standard web browser  
Unlimited number of units and users

Options:

- VID I Basic
- VID I Advanced
- VID I Premium



# CONTACT

# AVK INTERNATIONAL A/S

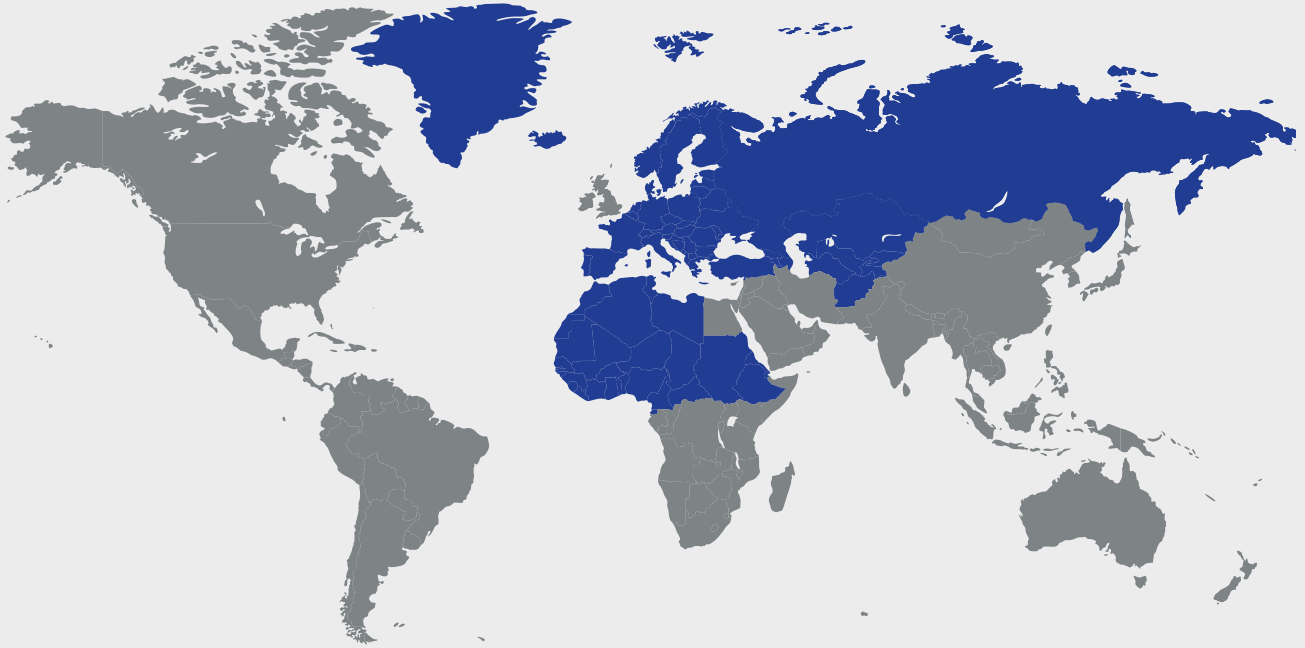

AVK International A/S is responsible for the geographical region consisting of Continental Europe, Russia, Central Asian countries, Caucasian countries and Northern Africa as per the map above. Please contact us directly or find your local contact in the list.

For the countries marked with grey colour please refer to [www.avkvalves.com](http://www.avkvalves.com) for contact information.

#### **AVK International A/S**

Bizonvej 1, Skovby  
DK-8464 Galten  
Denmark  
Tel: +45 8754 2100  
[www.avkvalves.eu](http://www.avkvalves.eu)

#### **AVK International A/S Rep. office the Baltic states**

Ozolu str. 28, K 1, Jaunmarupe  
Marupe county, LV 2166  
Latvia  
Tel: +371 256 219 95  
[jutr@avkgroup.com](mailto:jutr@avkgroup.com)

#### **AVK International A/S Rep. office Greece**

L. Vouliagmenis 85 (City Plaza)  
16674, Glyfada  
Athens, Greece  
Tel: +30 69 55 66 48 85  
[nisi@avkgroup.com](mailto:nisi@avkgroup.com)

#### **AVK International A/S Rep. office the Balkans**

Marsala Tolbuhina 44  
Belgrade  
Serbia  
Tel: +381 64 142 19 33  
[brmi@avkgroup.com](mailto:brmi@avkgroup.com)  
[www.avk.rs](http://www.avk.rs)

#### **AVK International A/S Rep. office Romania**

B-dul Agronomiei  
No. 8-16, Bl. N1.3  
Ap. 3, Sector 1  
Bucharest  
Romania  
Tel: +40 21 326 5017  
[office@avk.ro](mailto:office@avk.ro)  
[www.avk.ro](http://www.avk.ro)

#### **AVK International A/S Rep. office Turkey**

Ayazaga Mah., Dereboyu Cad. Meydan Sok. Veko Giz  
No:3/85  
34398 Maslak / Sarıyer / İstanbul  
Turkey  
Tel.: +90 212 403 95 85  
[issi@avkgroup.com](mailto:issi@avkgroup.com)

#### **AVK International A/S Rep. office Slovakia**

Vinne 136  
072 31 Vinne  
Slovakia  
Tel: +421 907 682 815  
[antmak@avkgroup.com](mailto:antmak@avkgroup.com)

# EXPECT GLOBAL LEADERSHIP AND LOCAL COMMITMENT



#### **AVK Danmark A/S**

Bizonvej 1, Skovby  
DK-8464 Galten  
Denmark  
Tel: +45 8754 2100  
salg@avk.dk  
www.avkventiler.dk

#### **Vatech 2000 ApS**

Værkstedsvej 15  
5500 Middelfart  
Denmark  
Tel.: +45 6440 2060  
admin@vatech.dk  
www.vatech.dk

#### **AVK Norge AS**

Hågasletta 7  
3236 Sandefjord  
Norway  
Tel: +47 33482999  
avk@avk.no  
www.avk.no

#### **AVK Sverige AB**

Industrigatan 28  
28143 Hässleholm  
Sweden  
Tel: +46 451 458 00  
sales@avkvalves.se  
www.avkvalves.se

#### **AVK Finland Oy**

Ilmailunkatu 21  
SF-33900 Tampere  
Finland  
Tel: +358 3 389 1822  
toimisto@avk.fi  
www.avkfinland.fi

#### **AVK France S.A.S.**

Z.I. de Villebarou  
4 rue de la Garbotière  
CS 2904  
41029 Blois Cedex  
France  
Tel: +33 2 54 74 23 13  
avk@avk.fr  
www.avk.fr

#### **AVK Válvulas S.A.**

Pol. Ind. Constantí  
Av. Europa, 27-31  
43120 Constantí - Tarragona  
Spain  
Tel: +34 977 543 008  
avk@avkvalvulas.com  
www.avkvalvulas.com

#### **AVK Magyarország Kft.**

Váci str. 91. / A. building 2nd floor  
1139 Budapest  
Hungary  
Tel: +36 30/987 14 75  
tbed@avkgroup.com  
www.avkvalves.hu

#### **AVK Nederland BV**

Radeweg 12  
P.O. Box 73  
8170 AB Vaassen  
The Netherlands  
Tel: +31 57 857 44 90  
info@avknederland.nl  
www.avknederland.nl

#### **AVK Armaturen GmbH**

Schillerstraße 50  
42489 Wülfrath  
Germany  
Tel.: +49 2058-901-01  
info@avk-armaturen.de  
www.avk-armaturen.de

#### **AVK Belgium NV**

Zoomstraat 6A  
9160 Lokeren  
Belgium  
Tel: +32 93481313  
info@avkvalves.be  
www.avkvalves.be

#### **AVK Armadan Sp. z o.o.**

ul. Jakubowska 1  
62-045 Pniewy  
Poland  
Tel: +48 61 291 20 01  
avk@avk.com.pl  
www.avk.com.pl

#### **AVK VOD-KA a.s.**

Labská 233/11  
412 01 Litoměřice, Předměstí  
Czech Republic  
Tel: +420 416 734 980  
obchod@vodka.cz  
www.avkvodka.cz

#### **InterApp Armaturen Holding AG**

Grundstrasse 24  
CH-6343 Rotkreuz  
Switzerland  
Tel: +41 (0) 41 798 22 33  
info@ch.interapp.net  
www.interapp.net

#### **InterApp Ges.m.b.H.**

Kolpingstrasse 19  
A-1230 Wien  
Austria  
Tel: +43 (1) 61 623 71-0  
info@at.interapp.net  
www.interapp.net

#### **AC.MO S.R.L.**

Via T. da Modena, 28 z.i.  
I-31056 Roncade (TV)  
Italy  
Tel: +39 0422 840220  
info@acmospa.com  
www.acmosrl.com

**AVK International A/S**

Bizonvej 1  
Skovby  
8464 Galten  
Denmark

Tel.: +45 8754 2100  
[www.avkvalves.eu](http://www.avkvalves.eu)

2024.02.23  
© 2024 AVK Group A/S - rev. 1

Expect... **AVR**